



®
701 GULLO AVENUE
ELK GROVE, IL 60007
Phone 847-640-7002
Fax 847-640-7008
sales@triteqlock.com

Crane Model 432D

Revised 9-24-07

Lock kit installation instructions



PARTS LIST

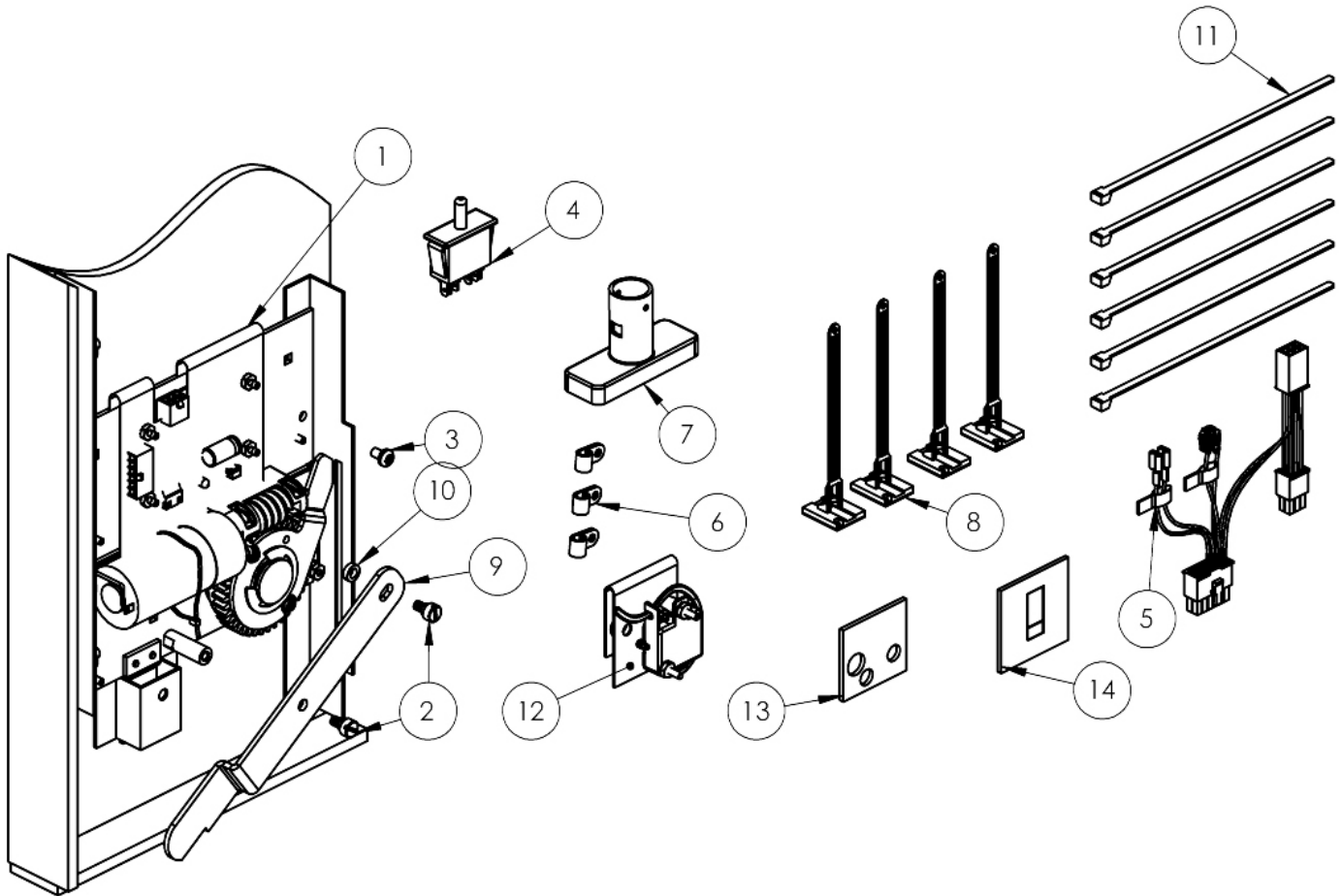

ITEM NO.	DESCRIPTION	QTY.
1	LOCK ASSEMBLY	1
2	SHLDR SCREW 1/4 X 1/8 10-32 LOCK	2
3	# 10-32 THREAD CUTTING SCREW	1
4	SWITCH	1
5	HARNESS	1
6	NYLON LOOP STRAP	3
7	T-HANDLE BLOCKER	1
8	TIE-ON BASE SCREW W/ADHESIVE	4
9	LOCK CAM	1
10	CAM SPACER	1
11	TIE-RAP	6
12	IR RECIEVER ASSEMBLY	1
13	DRILL TEMPLATE CHANGE CUP	1
14	TEMPLATE, SWITCH MOUNTING	1

Step 1 Remove T-handle and hardware



Step 2 Install an old lock core into the T-handle blocker [Item 7] so that the bolt on the lock core extends through the square opening in the T-handle blocker. Insert the T-handle blocker with the lock core into the T-handle housing, snapping in place.

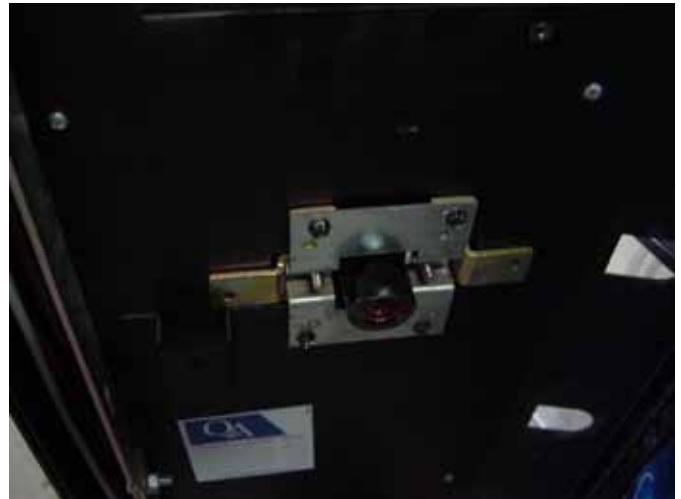

Step 3 Remove lower lock bar bolt and bushing. Retain bolt for future use. Remove bar and bushing and discard.



Step 4 Insert the tab located on the bottom of the lock [Item 1] into the bracket on the door (where lower lock arm was bolted in).

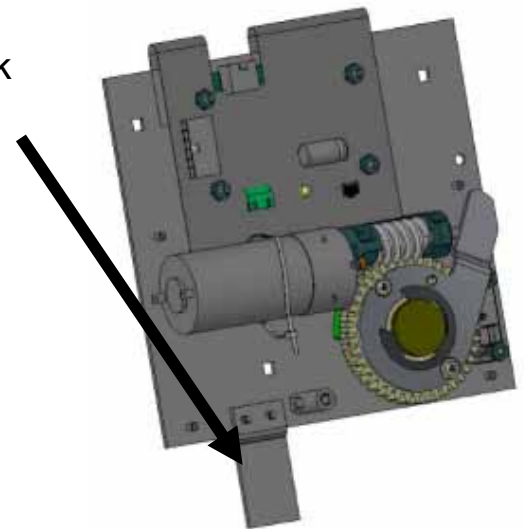

Step 5 Reinstall the bolt removed in step 3 and tighten securely.

Step 6 Install lock cam [Item 9] by inserting the small end into the vendor lift bar.



Step 7 Install (1) shoulder screw [Item 2] into lock [Item 1] passing through the center hole in the new lower lock arm. Do not tighten. Install (1) shoulder screw [Item 2] into lock [Item 1] passing the new lower lock arm and through the cam spacer [Item 10}. Tighten both screws securely making sure the lower lock arm is not fastened tight to the lock by the screws but will be free to rotate when the lock is operated.

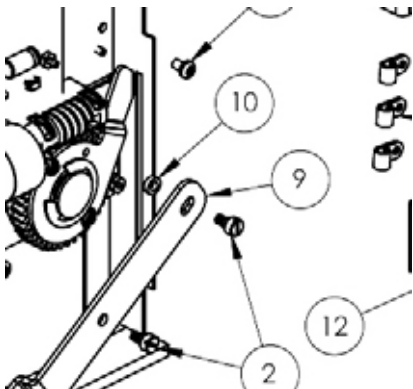

Step 8 Using the lock [Item 1] as a drill template, drill a 5/32 diameter hole in the back side of the door. Use care to only drill through the steel back of the door and not through the plastic front of the door. Install screw [Item 3] and tighten securely.

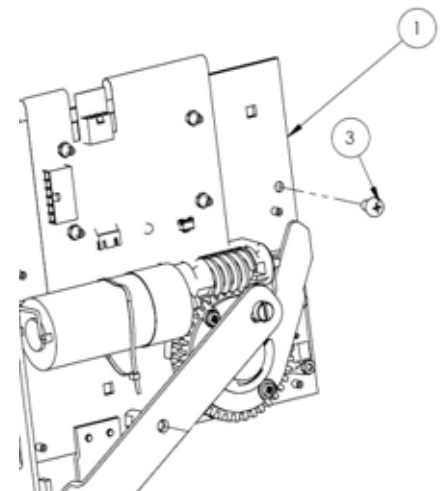

Step 9 Attach the self adhesive drill template to the back of the coin return cup. Drill (2) 3/8" holes and (1) 1/2" hole. It is not necessary to remove the template after drilling.

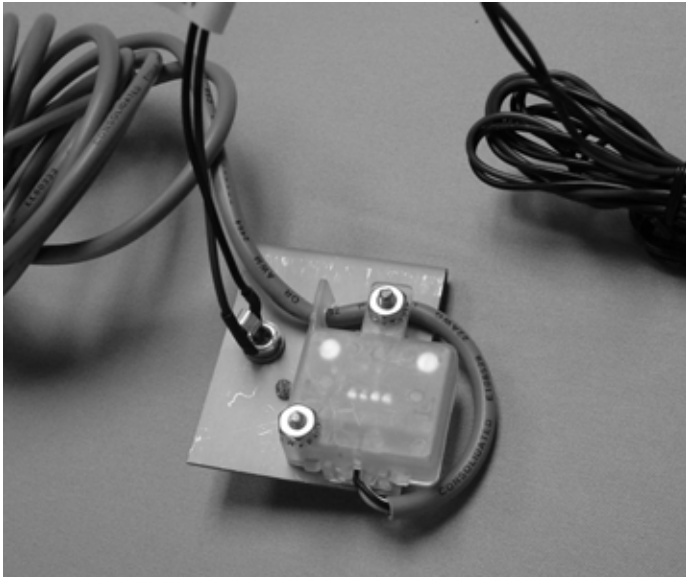

Step 10 Locate the harness [Item 5] and the IR receiver assembly [Item 12]. Install the battery jack from the harness into the IR receiver assembly as shown



Step 11 Remove door switch and discard. Attach the self adhesive switch mounting modification template over the old switch mounting rectangular hole. Using a grinder or cutting tool such as a Dremel, enlarge the hole to the size indicated on the template. Remove template. Snap switch [Item 4] into the new enlarged hole.

Step 12 Install the remainder of the wiring harness [Item 5] by plugging into the CPU and routing the wiring as needed. Install wire tie wraps [Item 11], nylon loop staps [Item 6], and tie on base wire clamps [Item 8] as needed.

Route the end of the wire with the two 6 pin connectors to the changer mechanism. Unplug the changer mechanism (it's a 6 conductor plug) and plug both ends into the lock harness. Carefully route any wire that must go from the door into the cabinet to prevent pinching or breaking of the wires.

Route the two wires with the fast on spade connectors to the switch installed in step 10) by connecting either of the 2 wires to the common terminal 1 of the new switch and connect the second wire to the N.O. 1 terminal.

Use care when routing wires to prevent pinching or cutting of the wires from moving parts.

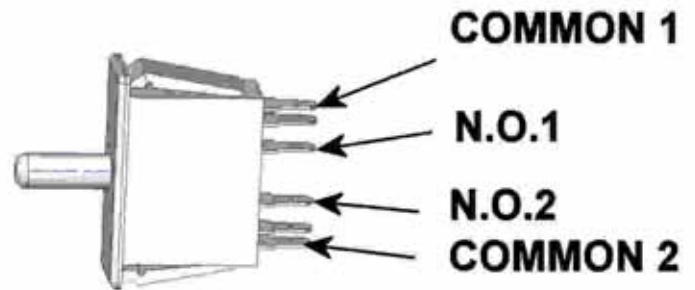

Step 13 Testing of the lock

IMPORTANT— do not close the door until lock installation is thoroughly tested.

Plug vendor into appropriate power source and turn on.

The lock is manufactured with a universal key code P1 programmed into the lock and the P1 code must be replaced with the end users zone and route keys . Do not lock the lock until the zone and route keys are installed (see programming of keys).

Press the switch from step 8 to initiate the lock closing.

Point either of the keys just programmed into the lock at the sensor (see step 11) and press the key button. Lock will open, moving the lift bar to the unlocked position.

Make sure the lift bar is moving freely and through the entire range of motion

Lock the vendor a second time and unlock with the other key.

Repeat lock and unlock with each key a minimum of 2 times before closing the door for the first time.

After the door is closed and locked, check door tightness. If the door is too loose, unlock the vendor and adjust the lift bar hooks. Caution, if the lift bar hooks are too tight, the lock may bind and not fully lock the vendor.

Programming the lock with new keys

To program the lock to your key code, locate the programming switch on the back of the circuit board (see arrow on figure). Depress and hold the programming switch until the LED turns solid on (see arrow in photo). Release the switch. Point the key fob to be programmed into the lock at the receiver and press the key fob button. The LED in the CPU will change from glowing bright to blinking. When the blinking stops, the new key is programmed into the lock.

Repeat for the second key.

